

# **THE COUNCIL OF THE BOROUGH OF MILTON KEYNES (VARIOUS ROADS WITHIN MILTON KEYNES AND SURROUNDING AREAS) (PROHIBITION OF STOPPING OUTSIDE SCHOOLS) ORDER 2008) VARIATION ORDER 2012**

The Council of the Borough of Milton Keynes ("the Council") in exercise of the powers of the said Council under Sections 1(1), 2(1) to (3), and (4(2) of the Road Traffic Regulation Act 1984 ("the Act of 1984") and of all other enabling powers and after consultation with the chief officer of police in accordance with Part III of Schedule 9 hereby makes the following Order: -

## **PART 1**

### **IMPLEMENTATION AND CITATION**

1. This Order shall come into operation on 15<sup>th</sup> March 2012 and may be cited as "The Council of the Borough of Milton Keynes (Various Roads within Milton Keynes and Surrounding Areas) (Prohibition of Stopping Outside Schools) Order 2008) Variation Order 2012".
2. Any reference in this Order to any enactment shall be construed as a reference to that enactment as amended by any subsequent enactment.
3. The plans annexed to this Order identify the lengths of roads subject to this Order, provided that where there is any inconsistency between the plans and the Articles it is the wording of the Articles which shall prevail.

## **PART 2**

### **VARIATIONS**

4. The Council of the Borough of Milton Keynes (Various Roads within Milton Keynes and Surrounding Areas) (Prohibition of Stopping Outside Schools) Order 2008" ("The Principal Order") is varied as provided by the following provisions of this Order:-
5. The following item NS102 in Schedule 1 of the Principal order is varied to the extent below:-

#### **Currier Drive, Neath Hill – south-east side**

NS102      From a point approximately 12 metres north-east of the centreline of the junction with Tower Drive, continuing for a distance of approximately 40 metres in a north-easterly direction.

6. The following items are inserted into Schedule 1 of the Principal Order as follows:-

#### **Singleton Drive, Grange Farm – south-west side**

NS125      From a point approximately 10.1 metres north-west of a point in line with the southern access road into Christ the Sower Primary School car park continuing for a distance of approximately 25.5 metres in a north-westerly direction.



**Notes:**



Prohibition of Stopping

**NS102**

TRO reference numbers

Map referred to in the Council of the Borough of Milton Keynes (Various Roads Within Milton Keynes and Surrounding Areas) (Prohibition of Stopping Outside Schools) Order 2008) Variation Order 2012

Map 1

Not to scale

The Common Seal of the Council of the Borough of Milton Keynes was hereunto affixed in the presence of:

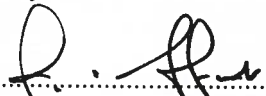
  
ASSISTANT DIRECTOR - LAW AND GOVERNANCE



20029

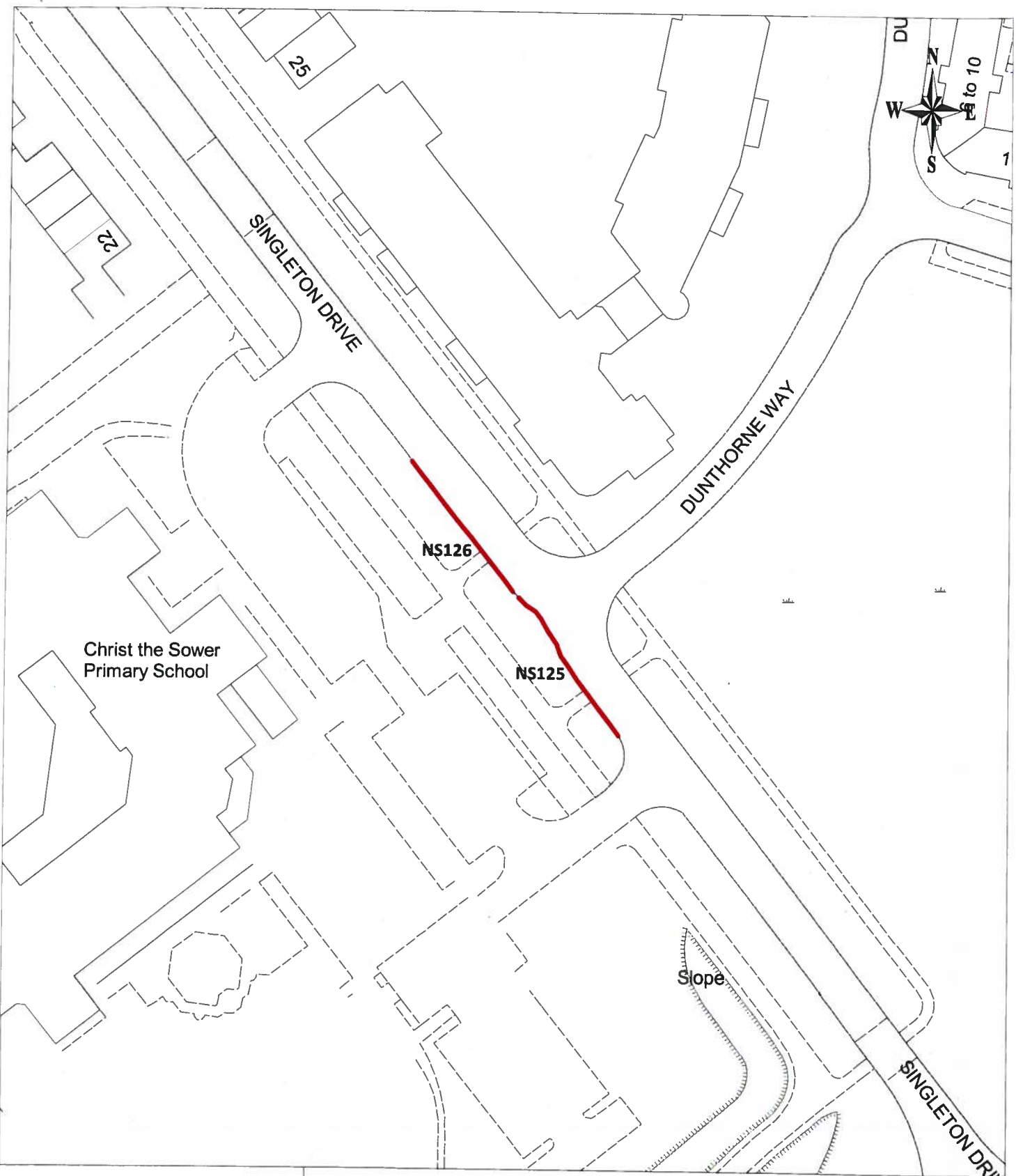

**Notes:**



Prohibition of  
Stopping

**NS125  
&  
NS126**

TRO reference  
numbers

Map referred to in the Council of the Borough of  
Milton Keynes (Various Roads Within Milton Keynes  
and Surrounding Areas) (Prohibition of Stopping  
Outside Schools) Order 2008) Variation Order 2012

Map 2

Not to scale

The Common Seal of the Council of the Borough of  
Milton Keynes was hereunto affixed in the presence of:

  
ASSISTANT DIRECTOR - LAW AND GOVERNANCE



20029

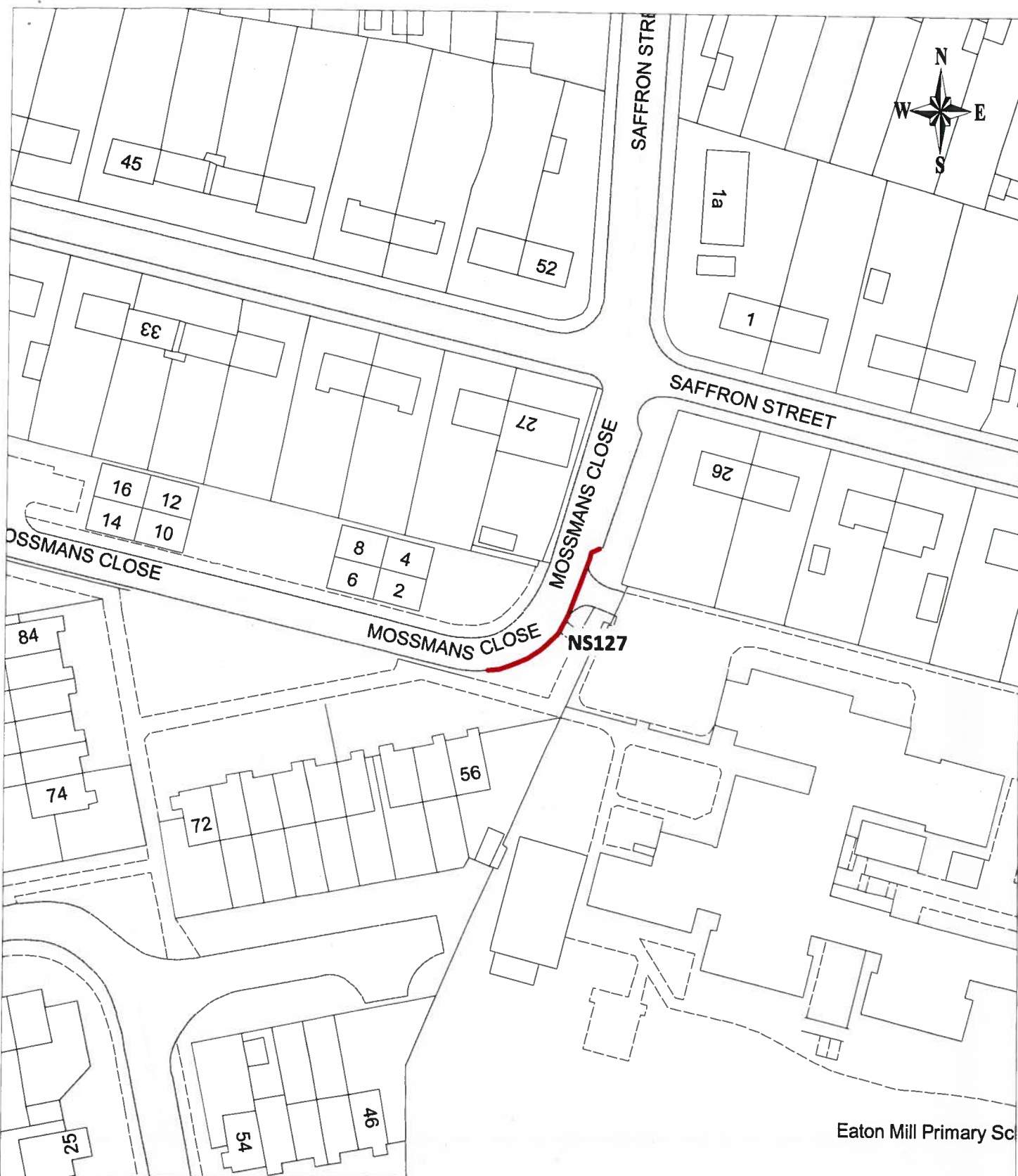

**Notes:**

 Prohibition of Stopping

**NS127** TRO reference numbers

Map referred to in the Council of the Borough of Milton Keynes (Various Roads Within Milton Keynes and Surrounding Areas) (Prohibition of Stopping Outside Schools) Order 2008) Variation Order 2012

Map 3

Not to scale

The Common Seal of the Council of the Borough of Milton Keynes was hereunto affixed in the presence of:

  
 ASSISTANT DIRECTOR - LAW AND GOVERNANCE



20029



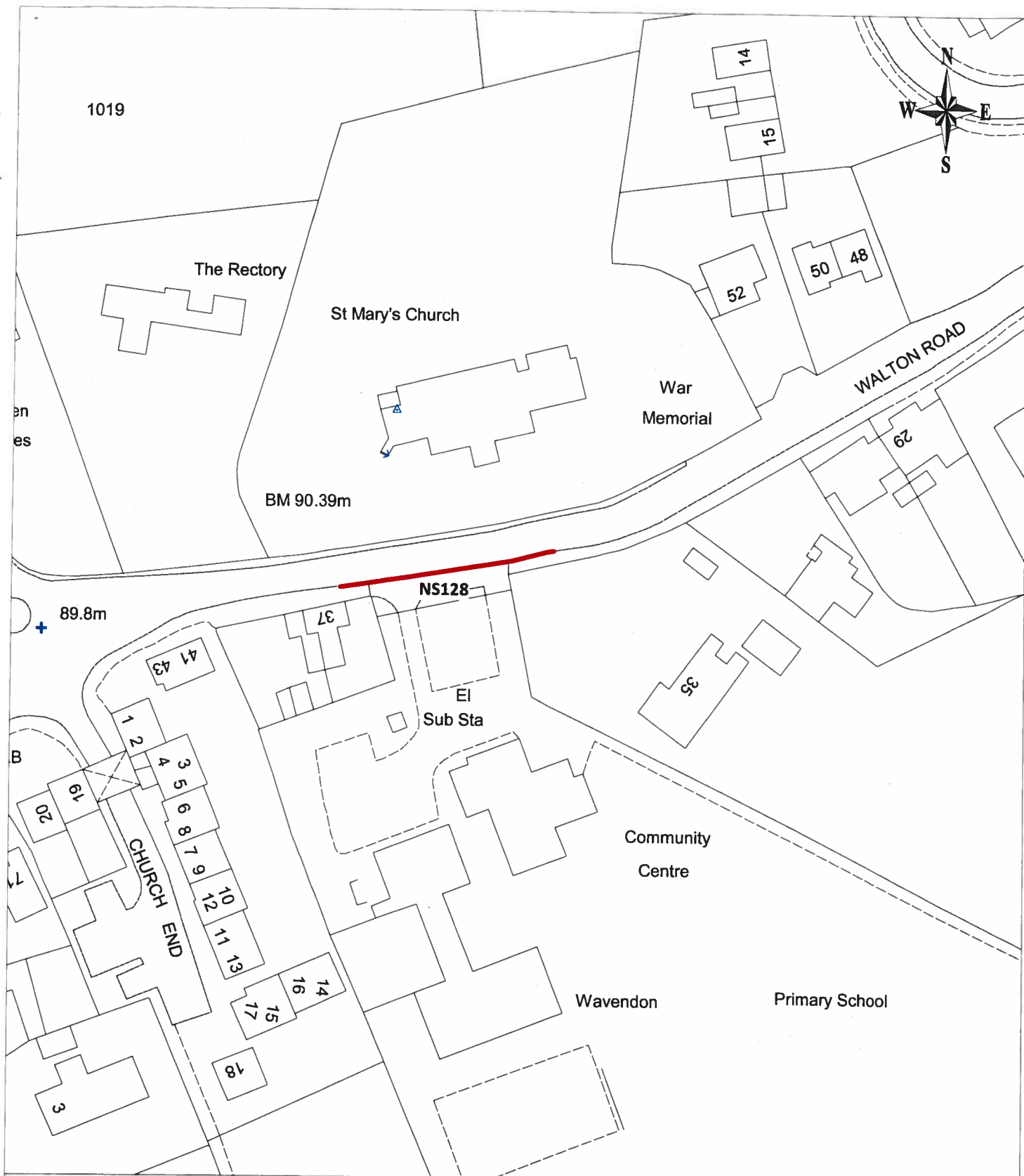

# Notes:

 Prohibition of Stopping

**NS128** TRO reference numbers

Map referred to in the Council of the Borough of Milton Keynes (Various Roads Within Milton Keynes and Surrounding Areas) (Prohibition of Stopping Outside Schools) Order 2008) Variation Order 2012

Map 4

Not to scale

The Common Seal of the Council of the Borough of Milton Keynes was hereunto affixed in the presence of:

  
 ASSISTANT DIRECTOR - LAW AND GOVERNANCE



20029

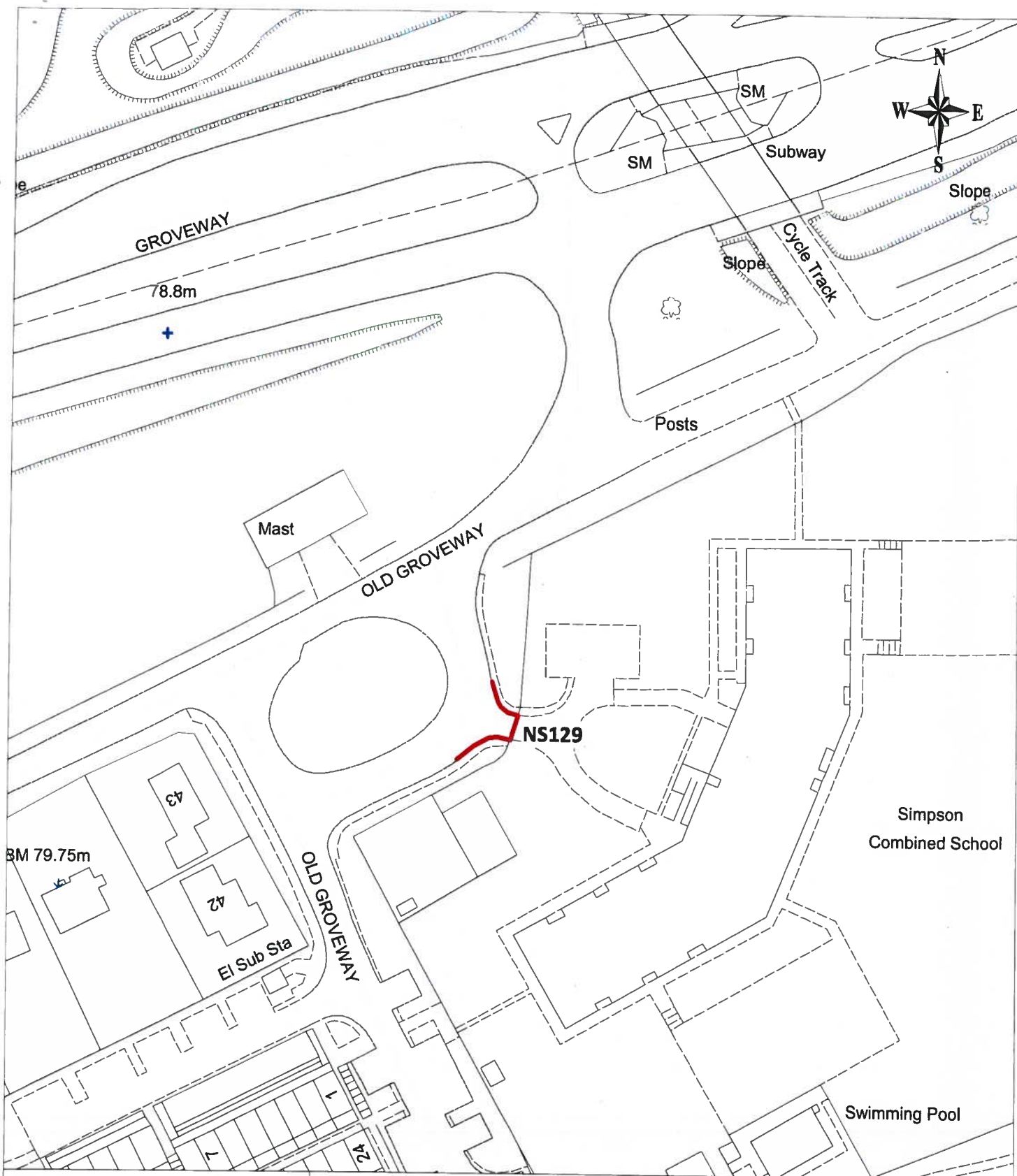

**Notes:**



Prohibition of Stopping

**NS129**

TRO reference numbers

Map referred to in the Council of the Borough of Milton Keynes (Various Roads Within Milton Keynes and Surrounding Areas) (Prohibition of Stopping Outside Schools) Order 2008) Variation Order 2012

Map 5

Not to scale

The Common Seal of the Council of the Borough of Milton Keynes was hereunto affixed in the presence of:

  
 ASSISTANT DIRECTOR - LAW AND GOVERNANCE



20029

NS126 From a point approximately 35.6 metres north-west of a point in line with the southern access road into Christ the Sower Primary School car park continuing for a distance of approximately 25.5 metres in a north-westerly direction.

**Mossmans Close, Bletchley – south-east side**

NS127 From a point approximately 24 metres south-west of its junction with Saffron Street, continuing for a distance of approximately 26 metres in a southerly then south-westerly direction.

**Walton Road, Wavendon – south side**

NS128 From a point approximately 6 metres west of the eastern boundary line of property number 37 Walton Road, continuing for a distance of approximately 37.5 metres in an easterly direction.

**Old Groveway, Simpson – south-east side**

NS129 From a point approximately 1 metre east of the eastern boundary line of property number 41 Old Groveway, continuing for a distance of approximately 25.5 metres in an easterly then northerly direction.

7. The following schools are inserted into Schedule 2 of the Principal Order:-

Christ the Sower Primary School, Singleton Drive, Grange Farm  
The Premier Academy, Saffron Street, Bletchley  
Simpson Combined School, Old Groveway, Simpson  
Wavendon Primary School, Walton Road, Wavendon

**THE COMMON SEAL of the COUNCIL OF THE  
BOROUGH OF MILTON KEYNES** was hereunto

affixed this 14<sup>th</sup> day of March 2012

in the presence of :-

.....  
**ASSISTANT DIRECTOR – ~~LAW AND GOVERNANCE~~**  
DEMOCRATIC SERVICES



20029